

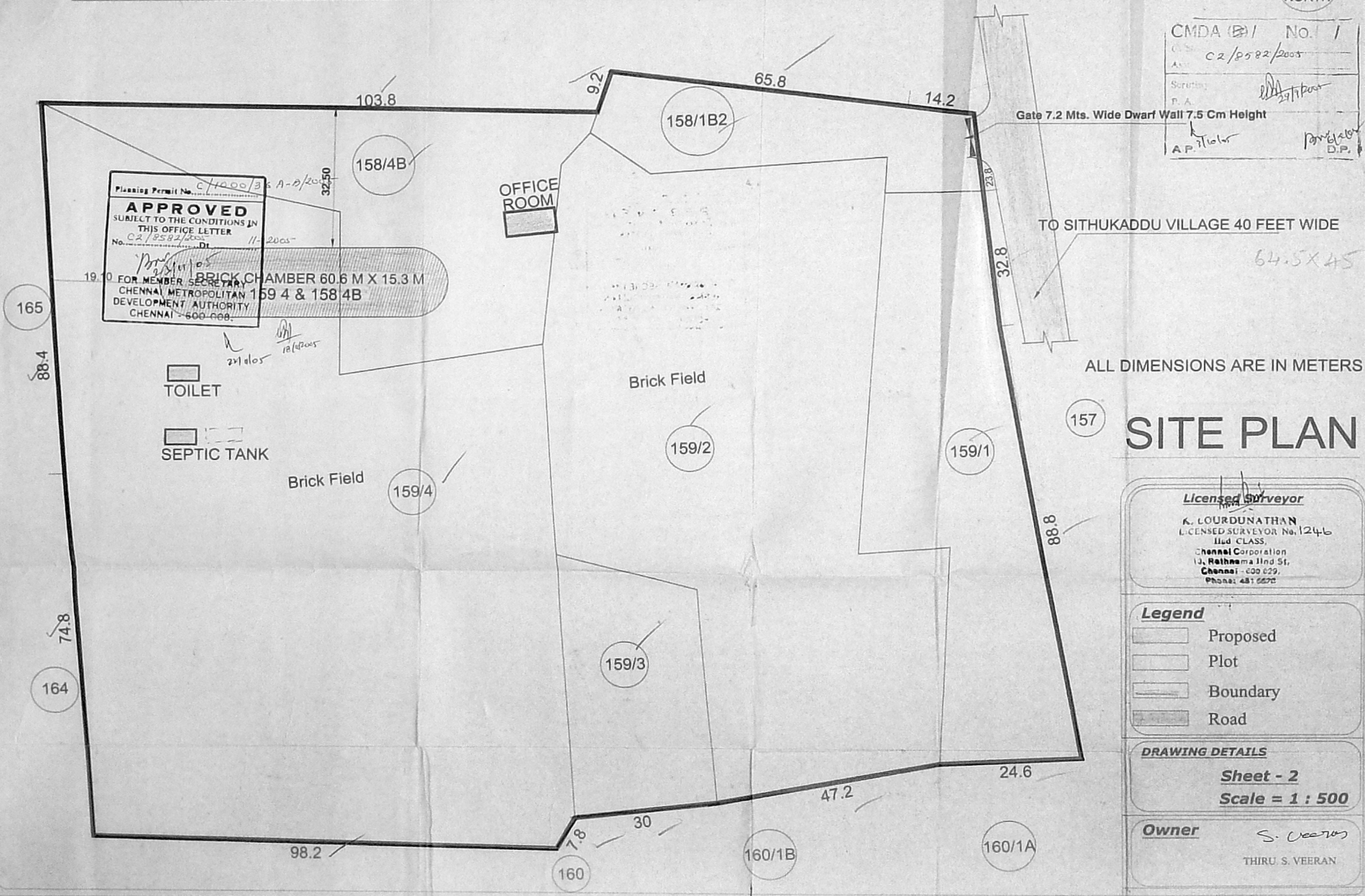

PLAN SHOWING PROPOSED CONSTRUCTION OF 24 UNIT S BRICK CHAMBER IN SURVEY NUMBER 158/1B2, 4B, 159/1,2,3,4 OF SITHUKADDU VILLAGE, POONAMALLEE PANCHAYAT UNION

CMDA (B) / No. / 1
 C. No. C2/8582/2005
 A. No. 11-2005
 Secretary P. A. [Signature]
 A.P. [Signature] D.P. [Signature]



Planning Permit No. C/4000/3 & A-D/2005
APPROVED
 SUBJECT TO THE CONDITIONS IN THIS OFFICE LETTER
 THIS OFFICE LETTER No. C2/8582/2005 Dt. 11-2005
 FOR MEMBER SECRETARY CHENNAI METROPOLITAN DEVELOPMENT AUTHORITY CHENNAI - 600 008.

TOILET
 SEPTIC TANK

Gate 7.2 Mts. Wide Dwarf Wall 7.5 Cm Height

TO SITHUKADDU VILLAGE 40 FEET WIDE

64.5 X 45

ALL DIMENSIONS ARE IN METERS

SITE PLAN

Licensed Surveyor

K. LOURDUNATHAN
 LICENSED SURVEYOR No. 1246
 IIud CLASS,
 Chennai Corporation
 13, Rathnambai Hind St,
 Chennai - 600 029,
 Phone: 481 6676

Legend

- Proposed
- Plot
- Boundary
- Road

DRAWING DETAILS

Sheet - 2
 Scale = 1 : 500

Owner

S. Veeran
 THIRU. S. VEERAN

